



CLIMB ON

UPPER ARM OUTRIGGER CONNECTOR REPLACEMENT

READ THESE INSTRUCTIONS COMPLETELY BEFORE YOU START. IF YOU DON'T UNDERSTAND THESE INSTRUCTIONS, PLEASE CALL 800-453-1192 FOR ASSISTANCE

Procedure for replacing the upper arm outrigger connector on Little Giant Ladder Systems **Cage** ladders.

1. Failure to comply with all instructions may result in serious injury.
2. Make sure this kit is compatible with your ladder. If you have any questions concerning the use of this kit on Little Giant Ladder Systems products, call 800-453-1192 for assistance.
3. Before installing this kit, identify all kit components. If any components are missing or damaged, please contact Customer Care. Do not substitute any components.
4. Inspect the ladder before installing this kit. Repair or replace any damaged or missing ladder parts before using the ladder. Use only Little Giant Ladder Systems repair or replacement parts. If you are unable to repair it, discard the ladder.

COMPONENTS IN KIT



(1) Upper Arm End Connectors



(2) 1/4" Center Lock Nut



(2) 11/64" Nylon Lock Nut



(2) Washers



(1) 5/16" Hex Head Shoulder Bolt



(1) 8/32" Socket Head Cap Screw

TOOLS NEEDED

Allen Wrench
9/64" & 5/32"



7/16" WRENCH



NOTE: IF ANY OTHER PART OF THE LADDER IS DAMAGED BEFORE OR DURING THE PROCESS OF INSTALLING AND/OR REPAIRING, DISCARD THE LADDER OR CONTACT CUSTOMER CARE FOR INSTRUCTIONS.

DO NOT USE A DAMAGED LADDER!



1. The Cage has 4 upper arm outrigger connectors.



2. Identify the upper arm outrigger connector that needs to be replaced.

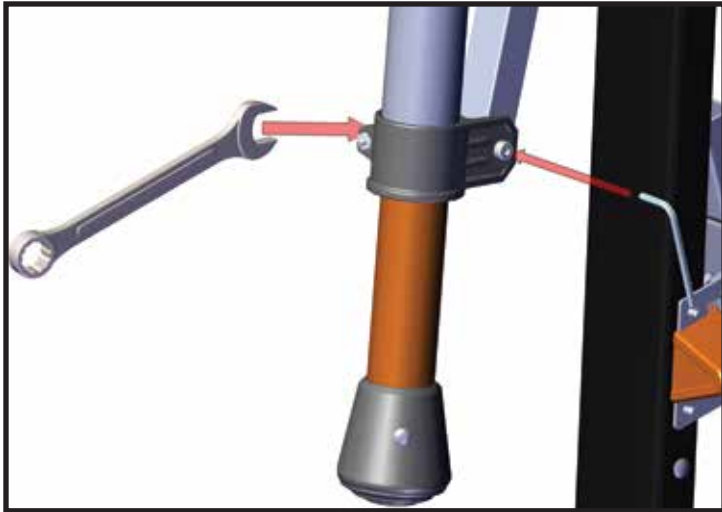

3. Using a 5/32" allen wrench and a 7/16" wrench, loosen the hex head shoulder bolt and lock nut.

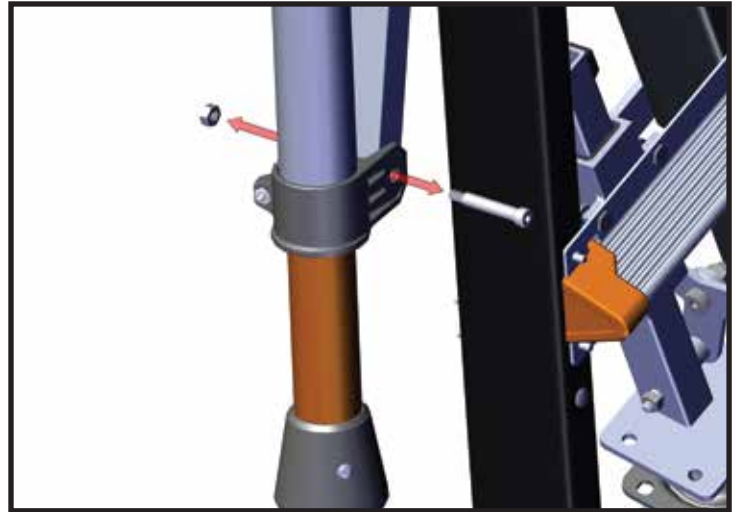

4. Once loose of the connector remove and discard the shoulder bolt and lock nut.



5. With a 9/64" allen wrench, loosen the socket head cap screw and lock nut.

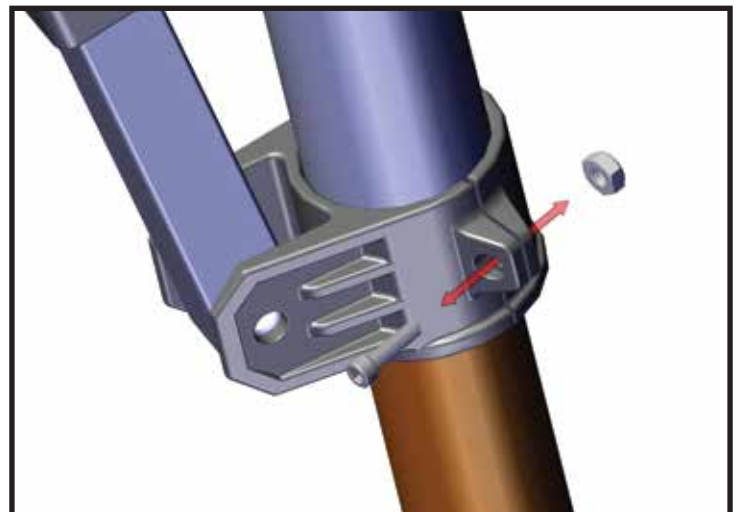

6. Once loose of the connector remove and discard the socket head cap screw and lock nut.

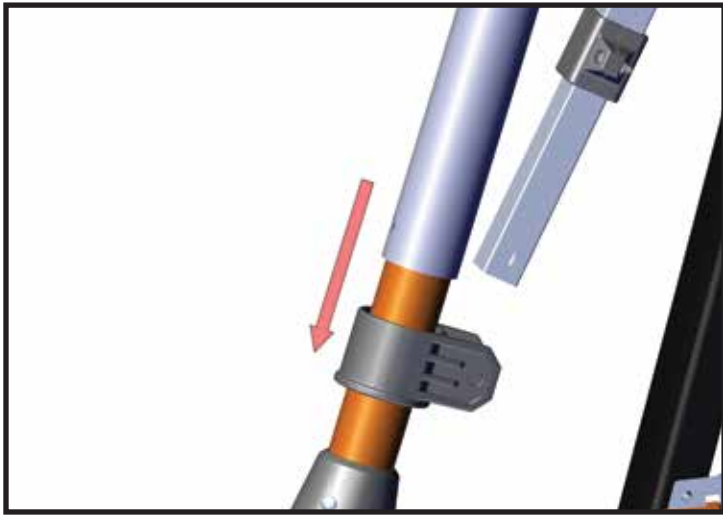

7. Slide the outrigger connector down the leg, free of the corresponding bar. (As shown in illustration)



8. Once the upper arm outrigger connector has been loosened, completely remove the extension leg from the body.



9. Once the extension leg is free from the body, slide the upper arm outrigger connector up and off of the extension leg.



10. Replace existing upper arm outrigger connector with the new upper arm outrigger connector that is included in kit.



11. Notice that on the inside of the upper arm outrigger connector that there is a small circular tab, which you will use in step 13.



12. Slide the existing extension leg into the body of the outrigger, as shown in the illustration.

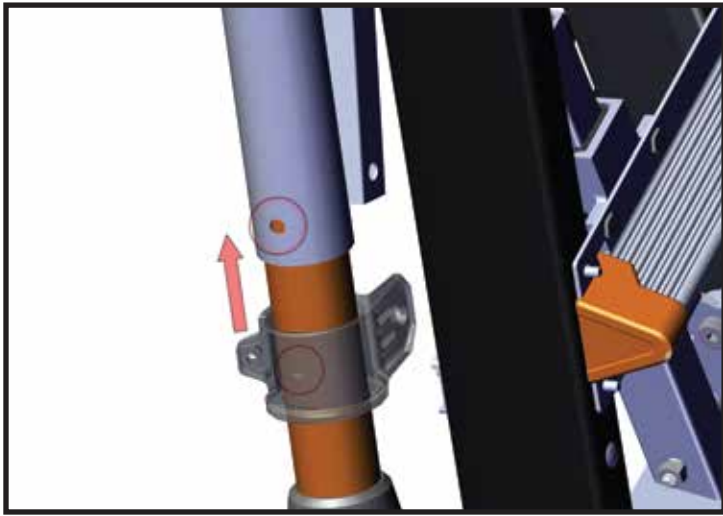

13. Line the small circular tab with the small circular hole at the base of the body of the outrigger. Proceed to slide the upper arm outrigger connector up and into place.

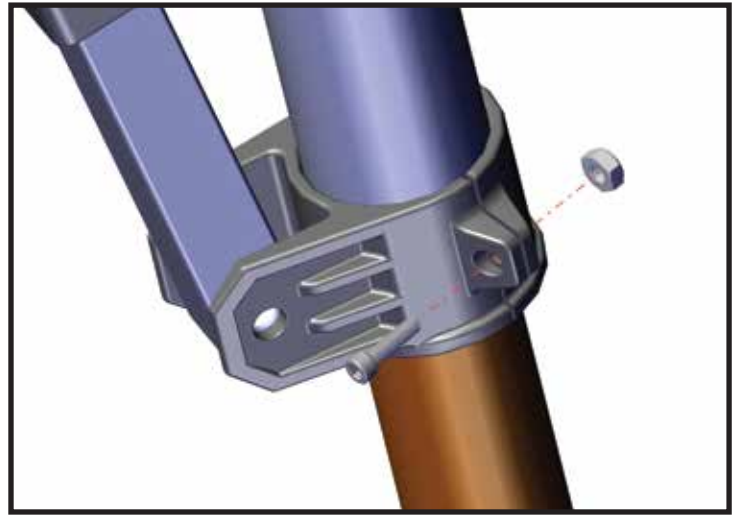

14. Insert the socket head cap screw through the outrigger connector, screw on with nylon lock nut.

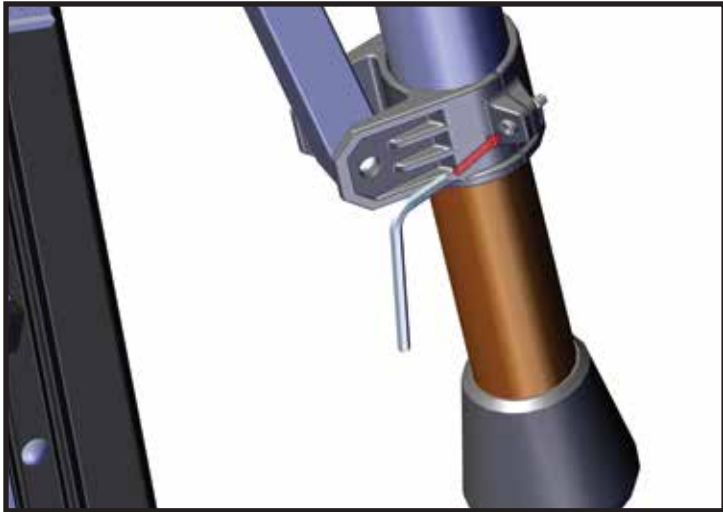

15. With an 9/64" allen wrench, tighten.

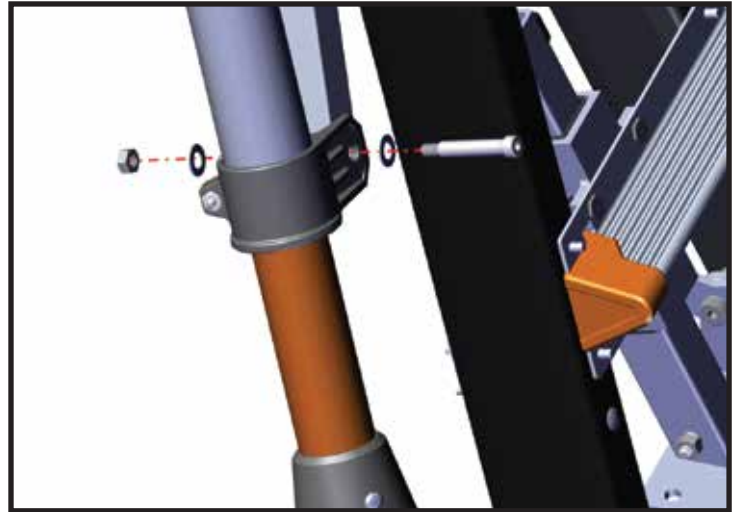

16. Insert the hex head shoulder bolt through the washer, outrigger connector, second washer and then screw on with center lock nut.

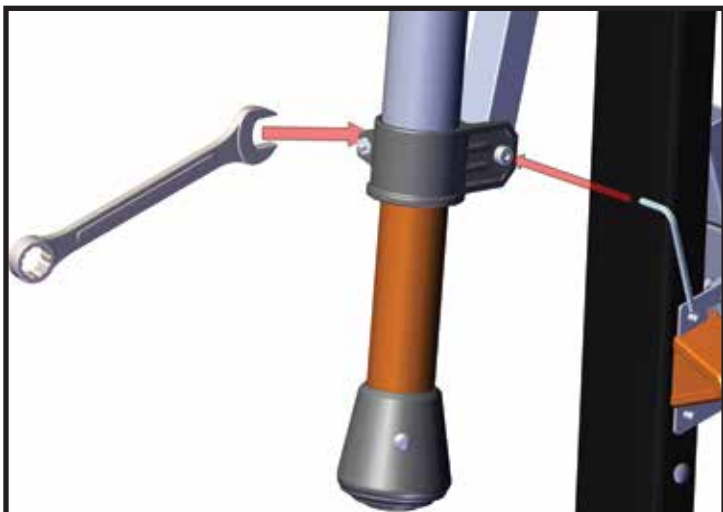

17. With a 5/32" allen wrench and 7/16" wrench, tighten.



18. Once all steps are completed, stand the ladder up and make sure it is completely stable before use.